

SMS

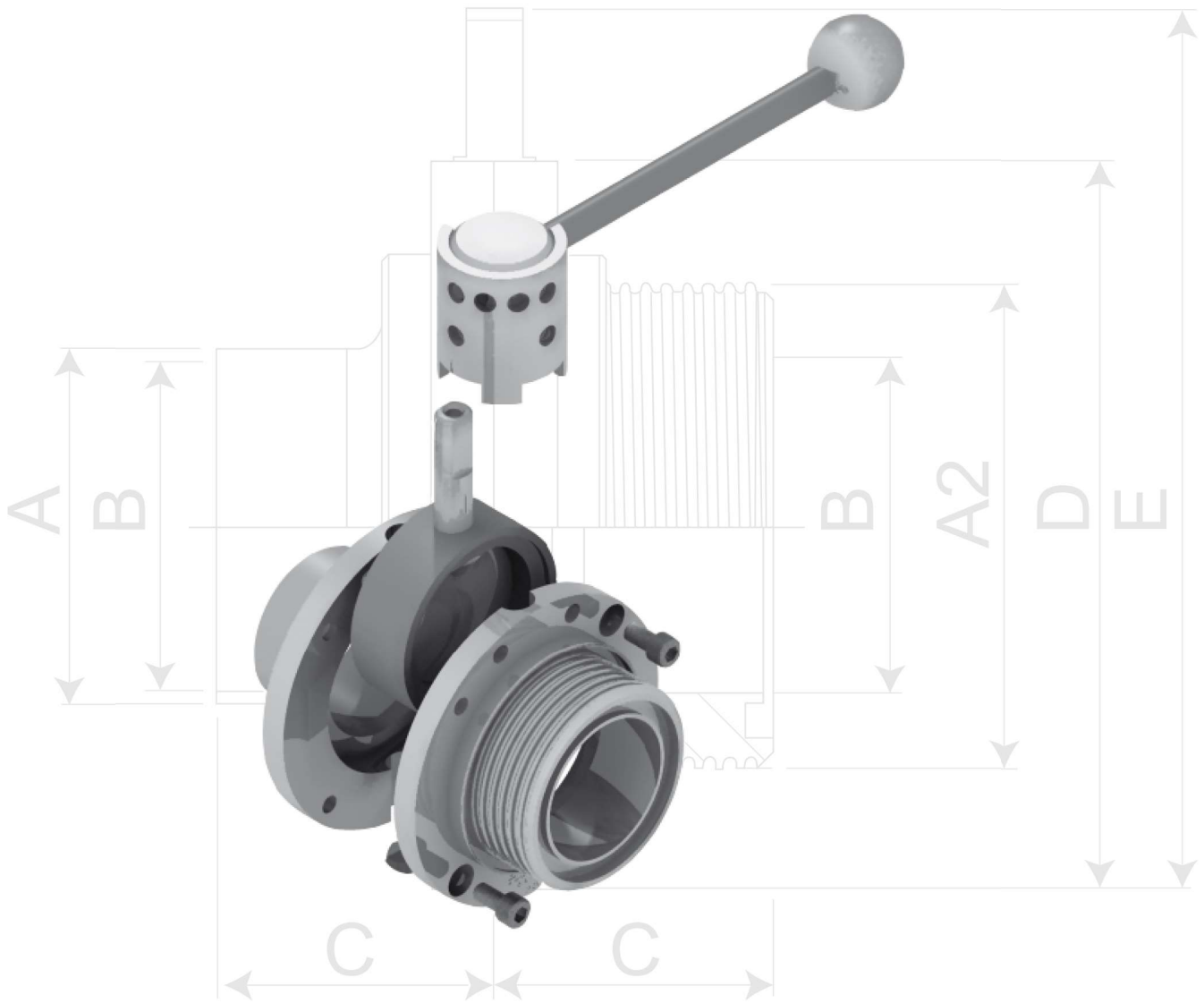

SODIME
PROCESS SOLUTIONS

Norme SMS

Norma SMS

Vanne papillon

Butterfly valve
 Válvula mariposa
 Затвор дисковый

Robinet à boisseau conique

3-way male plug cock
 Grifo 3 vías macho
 Конический кран трехходовый

Vanne à guillotine

Knife gate valve
 Válvula guillotina
 Затвор ножевой

Vanne à patin

Arc valve
 Válvula tipo «arco»
 Кран роликовый

Actionneur pneumatique et boîtier de contrôle

Pneumatic actuator and control box
 Actuador neumático y cabeza de control
 Пневматический привод и блок управления

Pièce de rechange de vanne papillon

Spare part for butterfly valve
 Pieza de repuesto para válvula mariposa
 Запасные части для затвора дискового

Poignée de vanne papillon

Handle for butterfly valve
 Manilla para válvula mariposa
 Ручка для затвора дискового

Clapet anti-retour

Non-return valve
 Válvula de retención
 Обратный клапан

Purgeur d'air

Air trap
 Purgador de aire
 Воздухоотвод

Indicateur de circulation et hublot

Sight glass and glass nut
 Mirillas ventanillas
 Диоптр трубный и гаечный

Manomètre

Manometer
 Manometro
 Манометр

SMS standard

Стандарт SMS

4 - 7

7

7

8

9 - 11

12

12 - 15

16

17

17 - 18

19

Soupape de décharge Safety pressure relief valve Valvula de descarga Клапан предохранительный	20
Filtre Filter Filtro Фильтр	21 - 22
Vanne à clapet Piston valve Válvula de asiento Клапан седельный	23 - 24
Raccord à souder, à ligaturer et à dudgeonner Welding, hose connecting and expanding union Unión a soldar, a ligar o a mandrinar Соединение резьбовое под сварку, под шланг и развальцовку	25 - 33
Clef de raccord Spanner for union Llaves para unión Ключ для резьбовых соединений	34
Raccord clamp Clamp union Unión clamp Зажимное соединение	35 - 41
Coude, té et réduction Elbow, tee and reducer Codo, te, reducción Отвод, тройник и переход	42 - 46
Collier de supportage Pipe hanger Soporte hexagonal Хомут для труб	47 - 48
Boule de nettoyage Spray ball Esprea de limpieza Моечная головка	48
Tube Pipe Tubo Труба	49

Vanne papillon lisse / lisse (EPDM)

Válvula mariposa extremos soldables (EPDM)

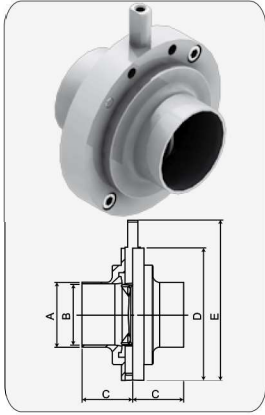

Butterfly valve weld / weld ends (EPDM)

Затвор дисковый Сварка / Сварка (EPDM)

CODE	DN		A	B	C	D	E
VPLL 6L JEP S 25	25	316L	25.00	22.50	34.00	79.00	101.00
VPLL 04 JEP S 25		304					
VPLL 6L JEP S 38	38	316L	38.00	35.40	38.00	85.00	107.00
VPLL 04 JEP S 38		304					
VPLL 6L JEP S 51	51	316L	51.00	48.00	40.00	105.00	127.00
VPLL 04 JEP S 51		304					
VPLL 6L JEP S 63	63.5	316L	63.50	60.20	40.00	112.00	134.00
VPLL 04 JEP S 63		304					
VPLL 6L JEP S 76	76.1	316L	76.10	72.10	41.00	125.00	147.00
VPLL 04 JEP S 76		304					
VPLL 6L JEP S 1016	101.6	316L	101.60	97.60	44.00	157.00	180.50
VPLL 04 JEP S 1016		304					
VPLL 6L JEP S 104	104	316L	104.00	100.00	44.00	157.00	180.50
VPLL 04 JEP S 104		304					

Joint FKM ou SILICONE sur demande / FKM or SILICON gaskets on request
Junta FKM o SILICONO a petición / Уплотнение ФKM и СИЛИКОН по запросу

Vanne papillon lisse / fileté (EPDM)

Válvula mariposa soldar / ferrúla roscada (EPDM)

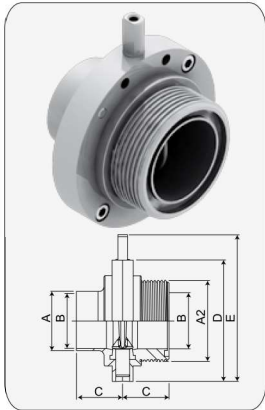

Butterfly valve weld / male ends (EPDM)

Затвор дисковый Сварка / Резьба (EPDM)

CODE	DN		A	A2	B	C	D	E
VPLF 6L JEP S 25	25	316L	25.00	40 x 1/6"	22.50	34.00	79.00	101.00
VPLF 04 JEP S 25		304						
VPLF 6L JEP S 38	38	316L	38.00	60 x 1/6"	35.40	38.00	85.00	107.00
VPLF 04 JEP S 38		304						
VPLF 6L JEP S 51	51	316L	51.00	70 x 1/6"	48.00	40.00	105.00	127.00
VPLF 04 JEP S 51		304						
VPLF 6L JEP S 63	63.5	316L	63.50	85 x 1/6"	60.20	40.00	112.00	134.00
VPLF 04 JEP S 63		304						
VPLF 6L JEP S 76	76.1	316L	76.10	98 x 1/6"	72.10	41.00	125.00	147.00
VPLF 04 JEP S 76		304						
VPLF 6L JEP S 1016	101.6	316L	101.60	125 x 1/4"	97.60	44+50	157.00	180.50
VPLF 04 JEP S 1016		304						
VPLF 6L JEP S 104	104	316L	104.00	125 x 1/4"	100.00	44+50	157.00	180.50
VPLF 04 JEP S 104		304						

Joint FKM ou SILICONE sur demande / FKM or SILICON gaskets on request
Junta FKM o SILICONO a petición / Уплотнение ФKM и СИЛИКОН по запросу

Vanne papillon fileté / fileté (EPDM)

Válvula mariposa extremos ferrúlas roscadas (EPDM)



Butterfly valve male / male ends (EPDM)

Затвор дисковый Резьба / Резьба (EPDM)

CODE	DN		A	B	C	D	E
VPFF 6L JEP S 25	25	316L	40 x 1/6"	22.50	34.00	79.00	101.00
VPFF 04 JEP S 25		304					
VPFF 6L JEP S 38	38	316L	60 x 1/6"	35.40	38.00	85.00	107.00
VPFF 04 JEP S 38		304					
VPFF 6L JEP S 51	51	316L	70 x 1/6"	48.00	40.00	105.00	127.00
VPFF 04 JEP S 51		304					
VPFF 6L JEP S 63	63.5	316L	85 x 1/6"	60.20	40.00	112.00	134.00
VPFF 04 JEP S 63		304					
VPFF 6L JEP S 76	76.1	316L	98 x 1/6"	72.10	41.00	125.00	147.00
VPFF 04 JEP S 76		304					
VPFF 6L JEP S 104	104	316L	125 x 1/4"	100.00	50.00	157.00	180.50
VPFF 04 JEP S 104		304					

Joint FKM ou SILICONE sur demande / FKM or SILICON gaskets on request
Junta FKM o SILICONO a petición / Уплотнение ФKM и СИЛИКОН по запросу

Vanne papillon CLAMP / CLAMP (EPDM)
Válvula mariposa extremos clamp (EPDM)

Butterfly valve CLAMP / CLAMP (EPDM)
Затвор дисковый Зажим / Зажим (EPDM)

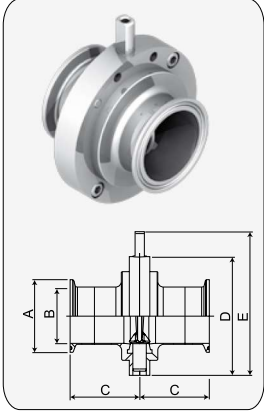

CODE	DN		A	B	C	D	E
VPFC 6L JEP S 25	25	316L 304	50.50	22.50	34.00	79.00	101.00
VPFC 04 JEP S 25							
VPFC 6L JEP S 38	38	316L 304	50.50	35.40	38.00	85.00	107.00
VPFC 04 JEP S 38							
VPFC 6L JEP S 51	51	316L 304	64.00	48.00	40.00	105.00	127.00
VPFC 04 JEP S 51							
VPFC 6L JEP S 63	63.5	316L 304	77.50	60.20	40.00	112.00	134.00
VPFC 04 JEP S 63							
VPFC 6L JEP S 76	76.1	316L 304	91.00	72.10	41.00	125.00	147.00
VPFC 04 JEP S 76							
VPFC 6L JEP S 1016	101.6	316L 304	119.00	97.60	50.00	157.00	180.50
VPFC 04 JEP S 1016							
VPFC 6L JEP S 104	104	316L 304	119.00	100.00	50.00	157.00	180.50
VPFC 04 JEP S 104							

Joint FKM ou SILICONE sur demande / FKM or SILICON gaskets on request
Junta FKM o SILICONO a petición / Уплотнение ФКМ и СИЛИКОН по запросу

Vanne papillon clampée / poignée K10 (EPDM) Clamp-assembling butterfly valve / handle K10 (EPDM)
Válvula mariposa con presión clamp / palanca K10 (EPDM)

Затвор дисковый зажимной / ручка K10 (EPDM)

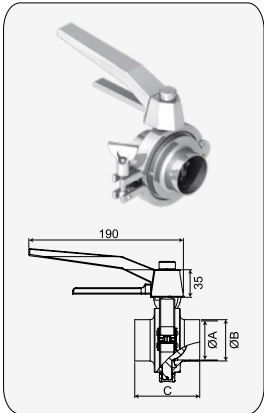

CODE	DN		A	B	C
VPCL 6L JEP S 25	25	316L 304	22.50	25.00	68.00
VPCL 04 JEP S 25					
VPCL 6L JEP S 38	38	316L 304	35.50	38.00	76.00
VPCL 04 JEP S 38					
VPCL 6L JEP S 51	51	316L 304	48.00	51.00	80.00
VPCL 04 JEP S 51					

Joint FKM ou SILICONE sur demande / FKM or SILICON gaskets on request
Junta FKM o SILICONO a petición / Уплотнение ФКМ и СИЛИКОН по запросу

Vanne papillon courte lisse / lisse (EPDM)
Válvula mariposa corta extremos soldables (EPDM)

Short butterfly valve weld / weld ends (EPDM)
Затвор дисковый короткий Сварка / Сварка (EPDM)

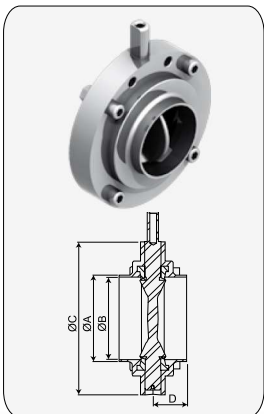

CODE	DN		A	B	C	D
VPLL 6L JEP S CT 25	25	316L 304	25.00	22.50	79.00	20.00
VPLL 04 JEP S CT 25						
VPLL 6L JEP S CT 38	38	316L 304	38.00	35.40	85.00	25.00
VPLL 04 JEP S CT 38						
VPLL 6L JEP S CT 51	51	316L 304	51.00	48.00	105.00	25.00
VPLL 04 JEP S CT 51						
VPLL 6L JEP S CT 63	63.5	316L 304	63.50	60.20	112.00	25.00
VPLL 04 JEP S CT 63						
VPLL 6L JEP S CT 76	76.1	316L 304	76.10	72.10	125.00	25.00
VPLL 04 JEP S CT 76						
VPLL 6L JEP S CT 1016	101.6	316L 304	101.60	97.60	157.00	32.00
VPLL 04 JEP S CT 1016						
VPLL 6L JEP S CT 104	104	316L 304	104.00	100.00	157.00	32.00
VPLL 04 JEP S CT 104						

Joint FKM ou SILICONE sur demande / FKM or SILICON gaskets on request
Junta FKM o SILICONO a petición / Уплотнение ФКМ и СИЛИКОН по запросу

Vanne papillon entre-bridés lisse / lisse (EPDM) Intermediate-flanged butterfly valve (EPDM)

Válvula mariposa entre bridas extremos soldables (EPDM)

Затвор дисковый межфланцевый Сварка / Сварка (EPDM)

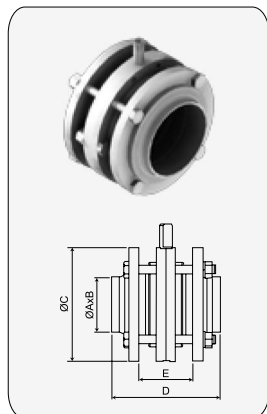

CODE	DN		A	B	C	D	E
VPLL EB 6L JEP S 25	25	316L	25.00	22.50	79.00	100.00	50.00
VPLL EB 04 JEP S 25		304					
VPLL EB 6L JEP S 38	38	316L	38.00	35.40	85.00	100.00	50.00
VPLL EB 04 JEP S 38		304					
VPLL EB 6L JEP S 51	51	316L	51.00	48.00	105.00	100.00	50.00
VPLL EB 04 JEP S 51		304					
VPLL EB 6L JEP S 63	63.5	316L	63.50	60.20	112.00	100.00	50.00
VPLL EB 04 JEP S 63		304					
VPLL EB 6L JEP S 76	76.1	316L	76.10	72.10	125.00	100.00	50.00
VPLL EB 04 JEP S 76		304					
VPLL EB 6L JEP S 1016	101.6	316L	101.60	97.60	157.00	100.00	50.00
VPLL EB 04 JEP S 1016		304					
VPLL EB 6L JEP S 104	104	316L	104.00	100.00	157.00	100.00	50.00
VPLL EB 04 JEP S 104		304					

Joint FKM ou SILICONE sur demande / FKM or SILICON gaskets on request
Junta FKM o SILICONO a petición / Уплотнение ФKM и СИЛИКОН по запросу

Vanne papillon mâle / femelle (EPDM)

Válvula mariposa macho / hembra (EPDM)

Butterfly valve male / female ends (EPDM)

Затвор дисковый Резьба / Гайка (EPDM)

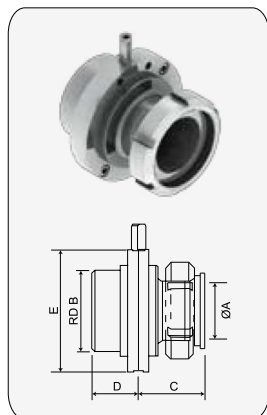

CODE	DN		A	B	C	D	E
RPMF 6L JEP S 25	25	316L	22.50	40 x 1/6"	38.00	34.00	79.00
RPMF 6L JEP S 38	38	316L	35.50	60 x 1/6"	38.00	38.00	85.00
RPMF 6L JEP S 51	51	316L	48.00	70 x 1/6"	40.00	40.00	105.00
RPMF 6L JEP S 63	63.5	316L	60.20	85 x 1/6"	40.00	40.00	112.00
RPMF 6L JEP S 76	76.1	316L	72.10	98 x 1/6"	41.00	41.00	125.00
RPMF 6L JEP S 104	104	316L	100.00	125 x 1/4"	50.00	50.00	157.00

Joint FKM ou SILICONE sur demande / FKM or SILICON gaskets on request
Junta FKM o SILICONO a petición / Уплотнение ФKM и СИЛИКОН по запросу

Vanne 3 voies 2 papillons en ligne

Válvula linear 3 vías 2 mariposas

3-way 2-spindle in-line valve

Затвор дисковый трехходовый 180°

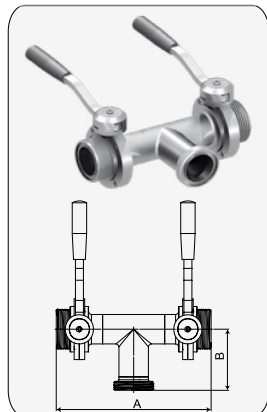

CODE	DN		A	B
VP3V JEP S 25	25	316L	194.00	55.00
VP3V JEP S 38	38	316L	198.00	70.00
VP3V JEP S 51	51	316L	209.00	82.00
VP3V JEP S 63	63.5	316L	210.00	105.00
VP3V JEP S 76	76.1	316L	220.00	110.00
VP3V JEP S 1016	101.6	316L	300.00	150.00
VP3V JEP S 104	104	316L	300.00	150.00

Joint FKM ou SILICONE sur demande / FKM or SILICON gaskets on request
Junta FKM o SILICONO a petición / Уплотнение ФKM и СИЛИКОН по запросу

Vanne 3 voies 2 papillons central / gauche et central / droite 3-way butterfly valve central / left and central / right
 Válvula 3 vías 2 mariposas central / izquierda y central / derecha Затвор дисковый трехходовый 90°

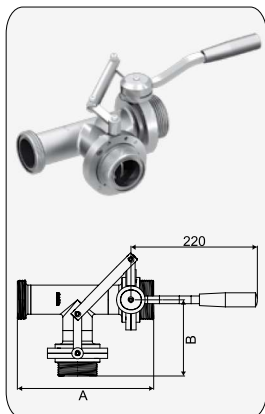

CODE	DN		A	B
VP3V CD JEP S25	25	316L	194.00	120.00
VP3V CD JEP S 38	38	316L	198.00	105.00
VP3V CD JEP S 51	51	316L	209.00	105.00
VP3V CD JEP S 63	63.5	316L	210.00	105.00
VP3V CD JEP S 76	70.1	316L	220.00	110.00
VP3V CD JEP S 1016	101.6	316L	300.00	150.00
VP3V CD JEP S 104	104	316L	300.00	150.00

Joint FKM ou SILICONE sur demande / FKM or SILICON gaskets on request
 Junta FKM o SILICONO a petición / Уплотнение ФKM и СИЛИКОН по запросу

Robinet à boisseau conique 3 voies fileté
 Grifo 3 vías macho

3-way male plug cock
 Конический кран трехходовый P/P/P

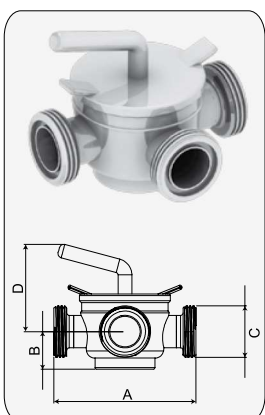

CODE	DN		A	B	C	D
RBF3 04 S 25	25	304	125.00	38.00	40 x 1/6"	90.00
RBF3 04 S 38	38	304	160.00	45.00	60 x 1/6"	117.00
RBF3 04 S 51	51	304	170.00	55.00	70 x 1/6"	122.00
RBF3 04 S 63	63.5	304	200.00	68.00	85 x 1/6"	142.00
RBF3 04 S 76	76	304	230.00	71.00	98 x 1/6"	154.00

Vanne à guillotine
 Válvula guillotina



CODE	DN		type
11770B.19	50	316	B
11770E.19	50	316	E
11770B.20	65	316	B
11770E.20	65	316	E
11770B.21	80	316	B
11770E.21	80	316	E

Knife gate valve
 Затвор ножевой

